

NEW PRODUCT!

Vertex™ Super-LED® Light (patent pending)

SINGLE, SELF-CONTAINED, HEMISPHERIC LIGHT



Officially Licensed Warning Lights Of NASCAR®



Actual Size!

Only 7/8" in height, this small hemispheric LED lighthouse is perfect for most applications where size and intensity are critically important.

Self-contained unit using an in-line combination lamp driver/flasher.

This new self-contained LED Hideaway requires only a one inch hole in any composite style head light, cornering light or tail light assembly to deliver true wide angle warning to the front, side and rear of your vehicle ... without interference to your vehicle computer and warning equipment! Less than 1" tall, it may also be surface mounted to outside surfaces anywhere on the vehicle!

Lamp Assembly

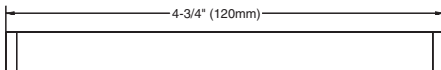
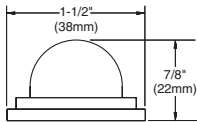

Lamp Driver

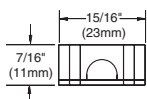

Available in Red, Amber White and Blue

Form# VTX0608

FEATURES

- Ultra small, self-contained, hemispheric LED light, for surface mount or internal mount within composite head lamps, cornering lamps and tail light assemblies.
- 25 Scan-Lock™ flash patterns, includes synchronize feature for alternating and synchronous flashing of multiple lamps.
- New lens technology enhances light distribution for optimum dispersion and intensity of the warning signal at critical angles.
- Includes pre-wired and sealed 9' neoprene cable to the lighthouse and lamp driver, with 4-22 gauge power, pattern and synchronize pigtail wires.
- Aluminum base and advanced thermal heat management system is designed for endless years of trouble free service.
- Lamp and in-line lamp driver are fully encapsulated for moisture and vibration resistance.
- Omni-directional lighthouse mounts in any position (orientation), vertically or horizontally.
- Available in red, amber, white and blue. LED color must match color of the lens it is installed behind, except for clear lens.

- 10 – 16 VDC.
- Virtually No RFI/EMI noise emitted, meets SAE J1113-41 Class 5.
- Two screws hold the lamp securely in place.
- 1" hole makes this LED module backwards compatible to HA238 and standard 1" Hide-A-Way style lamps.
- Simple installation with no separate lamp drivers, flashers, ballast or power supplies to install.

MODEL

VTX609*: Single lamp with 9' cable.

Replace * in model number with color desired:
A = Amber, B = Blue, R = Red, C = Clear/White



All Whelen Products are proudly designed and manufactured in the U.S.A.

WHELEN®

ENGINEERING COMPANY, INC.

51 Winthrop Road
Chester, CT 06412-0684
(860) 526-9504 • Fax (860) 526-4078
www.whelen.com

Engineers for the Emergency Warning Industry

Vertex™ Super-LED® Light

© 2008 Whelen Engineering Co., Inc. Printed in U.S.A.
Whelen Engineering Inc. reserves the right to upgrade and improve products without notice.
NASCAR® is a registered trademark of the National Association for Stock Car Auto Racing, Inc.
Code No. 12187A-0708