



Technology with Vision

HERO

HELLA UNDERCOVER HIDEAWAY



HERO VEHICLE OVERVIEW



HERO Hideaway

Overview



HERO
HELLA UNDERCOVER HIDEAWAY





	Model	Year	Page
FORD	Police Interceptor Utility	2020 -	4
	Explorer	2016 - 2019	5
	F150	2016 - 2018	6
	F150/250	2019 - 2020	7
	F250	2017 - 2020	8
	Ranger XL	2020 -	9
	Escape	2020 -	10
	Expedition	2018 - 2020	11
CHEVY	Tahoe	2015 - 2020	12
	Silverado 1500	2019 - 2020	13
	Colorado	2020 -	14
	Tahoe - NEW	2021 -	15

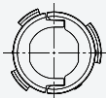
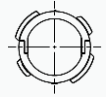

HERO Hideaway

Part number overview

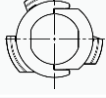
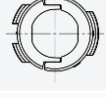
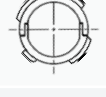

Version	Hella part number	Design
HERO Adapter A1	358118301	
HERO Adapter A2	358118311	
HERO Adapter A3	358118321	
HERO Adapter A4	358118331	
HERO Adapter A5	358118341	
HERO Adapter A6	358118351	
HERO Adapter A7	358118391	
Chevy headlight harness	358118371	

	Hella part number	Color
HERO Lighthead	358118101	White
HERO Lighthead	358118111	Amber
HERO Lighthead	358118121	Red



HERO Vehicle Overview

Ford Police Interceptor Utility (2020 - ...)



HERO
HELLA UNDERCOVER HIDEAWAY



HERO Vehicle Overview

Ford Explorer (2016 – 2019)



HERO
HELLA UNDERCOVER HIDEAWAY

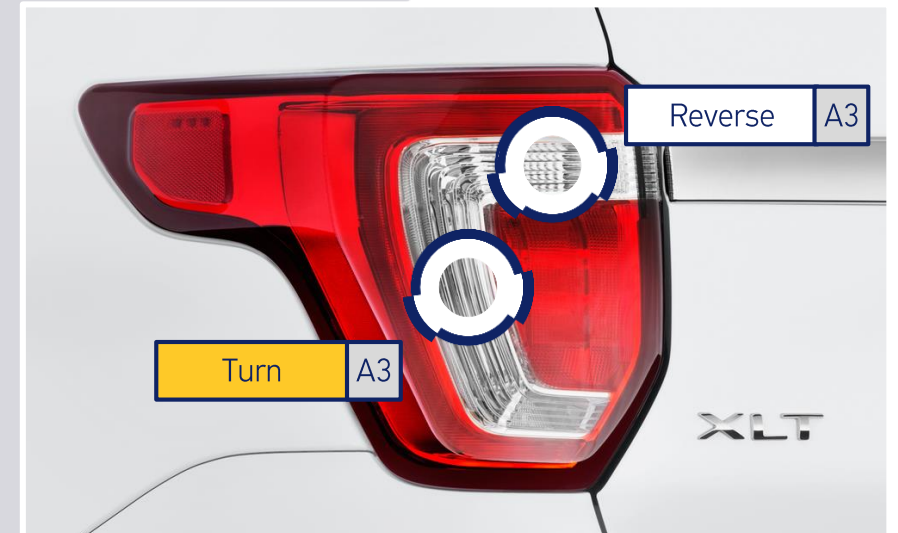

HERO Vehicle Overview

Ford F150 (2016 - 2018)



HERO
HELLA UNDERCOVER HIDEAWAY

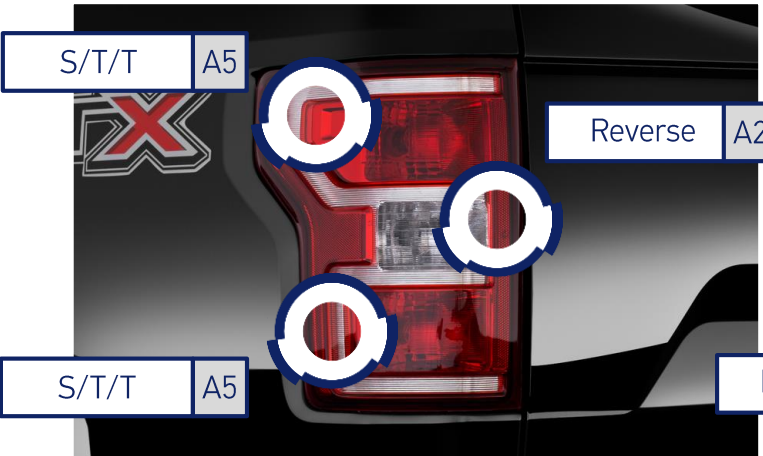

3 Chamber version

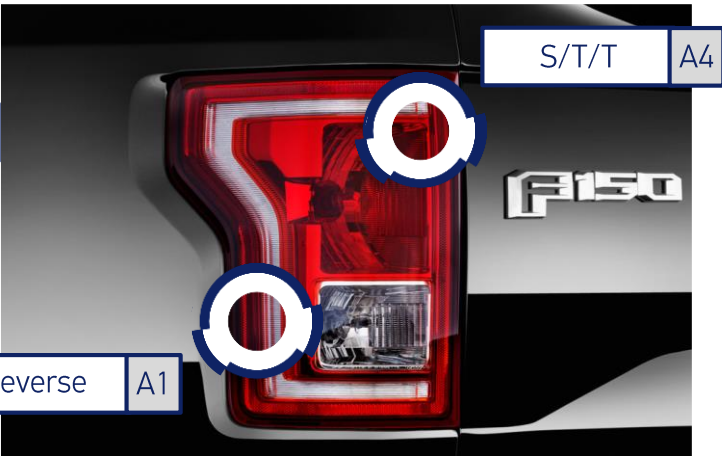

2 Chamber version

HERO Vehicle Overview

Ford F150/F250 (2019 - 2020)



HERO

HELLA UNDERCOVER HIDEAWAY



IMPORTANT:

The 2020 Ford F-150/250 trucks use different sockets at the front turn bulb. Some models need adapter A3, some adapter A6.

Ford changed the electronics on their latest Ford Pickup trucks F-150, F-250 (2019 – 2020 models). HERO install tests showed, that the Ford electronics interfere with the park/turn function of the HERO Hideaway. This interference causes HERO to flicker in parking/turn mode, but only the first batch (3/2020) of HEROs produced.

→ HELLA's simple fix for the first batch of HERO hideaways is this **in-line capacitor cable**.

More information about this In-line cable on our website: www.hellahero.com

Information: In case you can't insert the HERO integration connector into the OE bulb sockets, cut off the tabs on the side. The connector will still grab the socket and will sit tight.

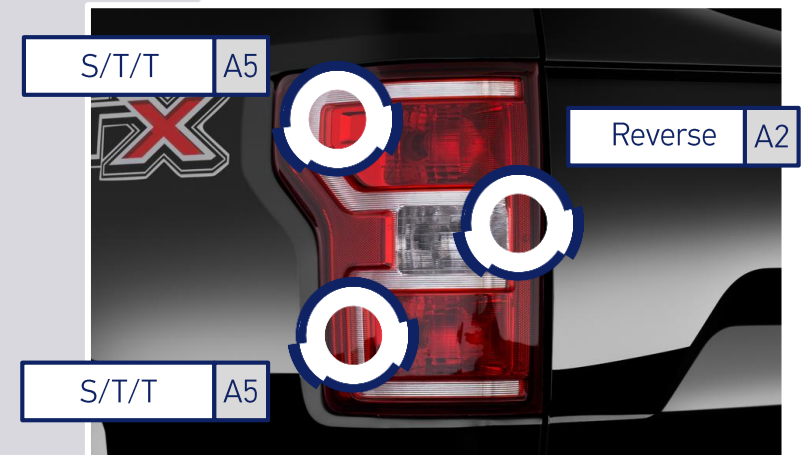
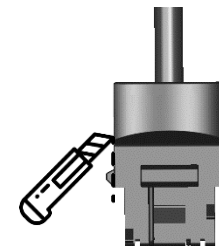

3 Chamber version

HERO Vehicle Overview

Ford F250 (2017 - 2020)



HERO
HELLA UNDERCOVER HIDEAWAY

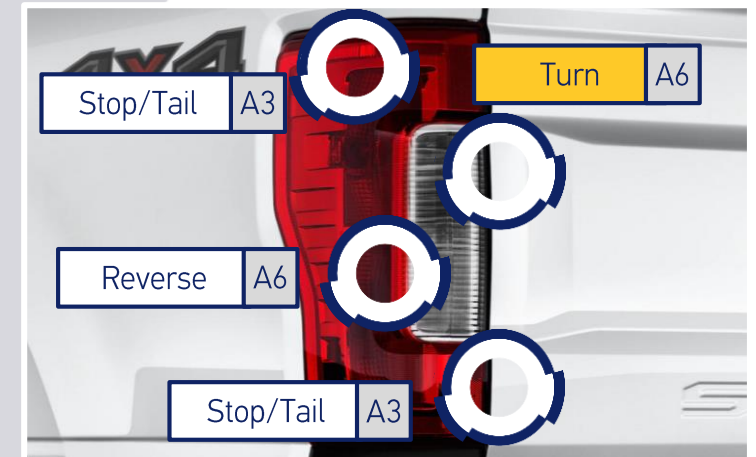
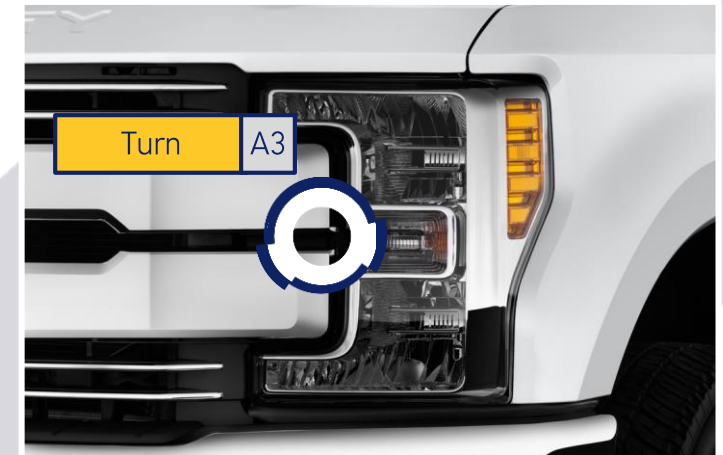

HERO Vehicle Overview

Ford Ranger XL (2020 - ...)



HERO
HELLA UNDERCOVER HIDEAWAY

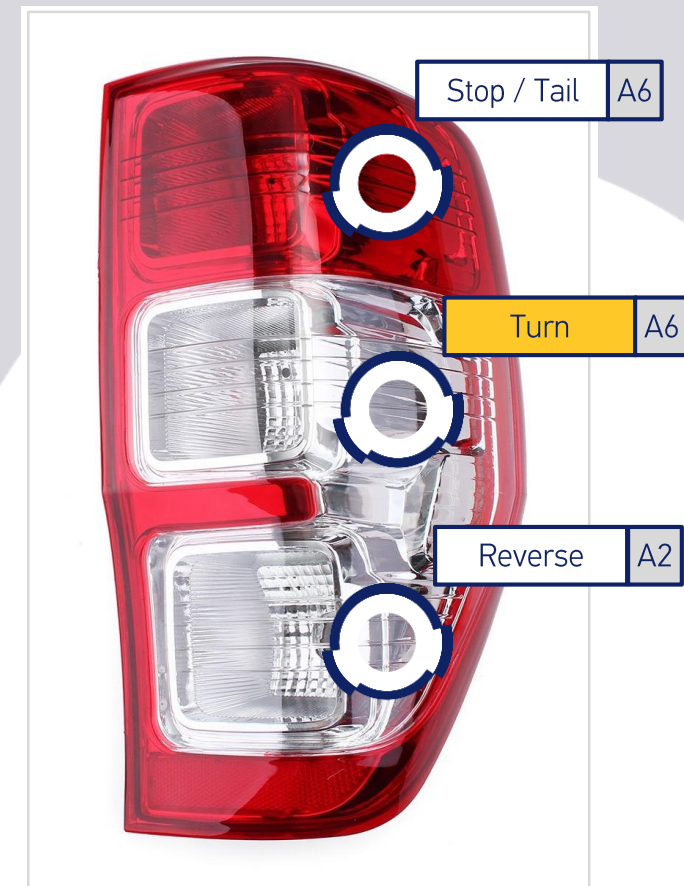

HERO Vehicle Overview

Ford Escape (2020 - ...)



HERO
HELLA UNDERCOVER HIDEAWAY



INFORMATION:

To insert HERO in the front turn chamber of the 2020 Ford Escape headlight, you need to use adapter A6. You might have to slightly trim one tab on the headlight hole, to insert HERO properly.

Please note: This will not affect the headlight when returning it to the OE incandescent bulb.



HERO Vehicle Overview

Ford Expedition (2018 - 2020)



HERO
HELLA UNDERCOVER HIDEAWAY

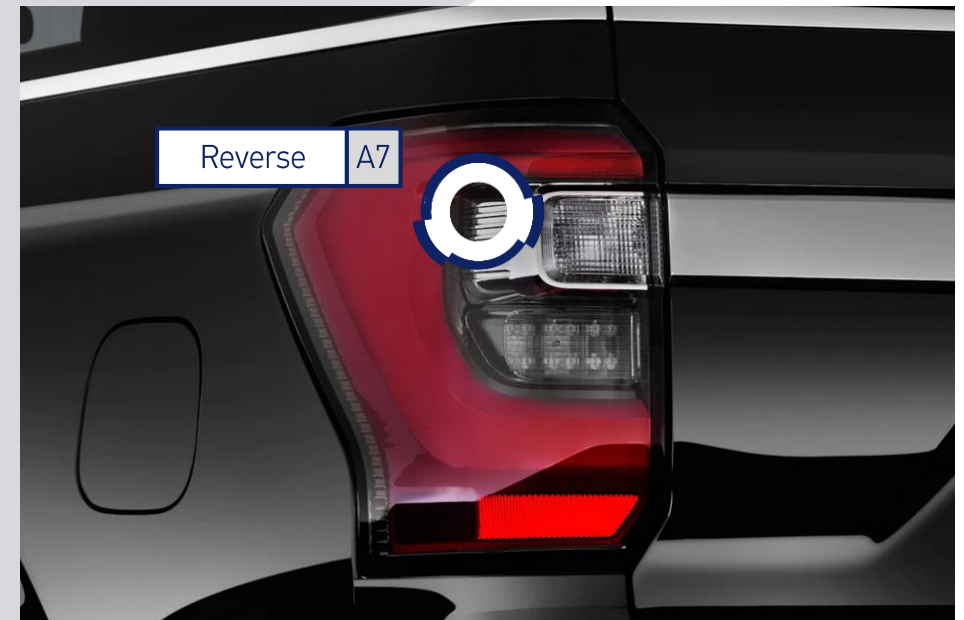

HERO Vehicle Overview

Chevy Tahoe (2015 - 2020)



HERO
HELLA UNDERCOVER HIDEAWAY

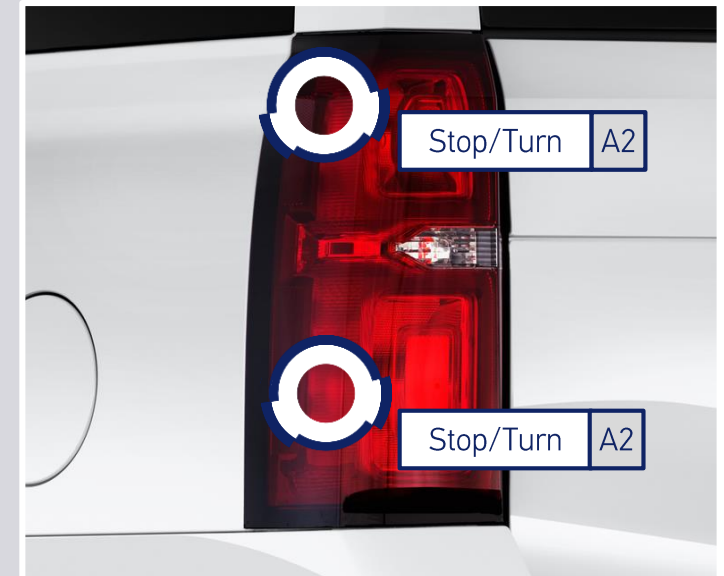

HELLA's recommendation:

Use the Chevy adapter harness (PN: 358118371) for a smooth and clean HERO install in the Front Turn Signal. This harness works as a connecting link between the 8-pin OE plug on the headlight and the vehicle OE harness. It has a bulb socket attached, that gets the current for the turn signal (+/-) directly from the car.

→ HERO gets the OE signal without cutting wires or damage of OE components.

More information about this adapter harness on our website: www.hellahero.com



HERO Vehicle Overview

Chevy Silverado 1500 (2019 - 2020)



HERO
HELLA UNDERCOVER HIDEAWAY

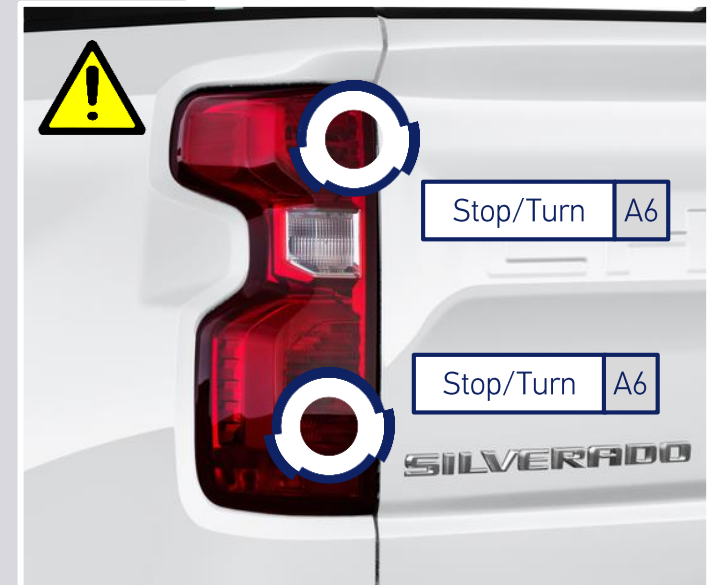

IMPORTANT:

1) The new Chevy Silverado has 2 amber positions in the front.

- Top chamber: Park
- Bottom chamber: Park & Turn

HELLA's recommendation: Use HERO only in the top chamber with the Chevy adapter harness (PN: 358118371)

More information about this adapter harness on our website: www.hellahero.com

2) Chevy did some changes in their vehicle electronic circuit on their 2020 models.

In the rear positions (S/T/T), HERO fits with the A6 adapter, but it starts fast flashing after 20 seconds.

We are already investigating the cause and working on a fix.



HERO Vehicle Overview

Chevy Colorado (2020 - ...)



HERO
HELLA UNDERCOVER HIDEAWAY

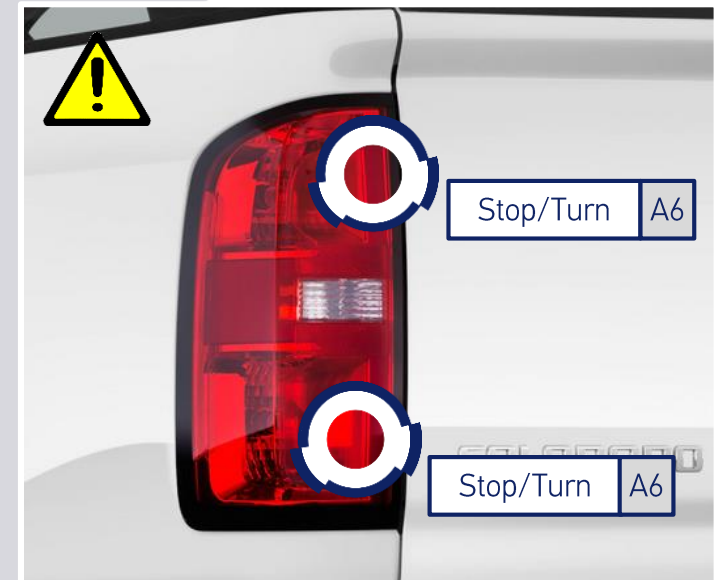

INFORMATION:

Chevy did some changes in their vehicle electronic circuit on the 2020 Silverado. The new 2020 Colorado might be the same, where HERO starts fast flashing. We are investigating this model and will update the information accordingly.



HERO Vehicle Overview

Chevy Tahoe (2021 - ...)

Upcoming model



HERO
HELLA UNDERCOVER HIDEAWAY

